

Trilock 900



Versatile tripod security barrier

The Trilock 900 provides an effective means of controlling pedestrian access, characterised by its extremely reliable mechanism, stylish design and space efficiency.

Available in various different models, the Trilock 900 is a versatile barrier, providing a suitable security barrier for almost every situation.

The Trilock 900 consists of one frame, comprising electronics and a tripod mechanism, which can be customized with various exchangeable cladding elements. This modular concept provides a variety of models to match existing style elements in all possible surroundings.

The attractive design of the Trilock 900 makes it particularly suitable for environments such as reception areas in corporate, governmental and financial offices, museums and passenger terminals. The Trilock 900 is simple to install directly onto the finished floor or even onto a temporary portable floor.

Your **Security.** Our **Solution.**

Working principle

The Trilock 900 is always locked in a rest position, but will open in the desired direction when authorisation is granted via an access control system, or external control panel at, for example, a reception desk.

Once authorisation is given, the mechanism unlocks for a rotation of 120°. By pushing the armset of the mechanism, access is given to one person, where after the mechanism locks. An optional authorisation display continuously indicates the status of the mechanism with a two-colour arrow/cross image.

Operating modes

The Trilock 900 is available with different mechanisms, providing a variety of electrical operating modes, realising bi-directional control. The electrically controlled Trilock 900 controls and blocks the system electro-mechanically and can be equipped with most access control systems by using potential free contacts.

Software controlled

All software reprogramming is carried out using an external PDA, allowing fault finding and functionality adjustments to be made without the need for disassembly.



Options

- Rigid or collapsible armset
- Fail-safe or fail-secure, entry or exit
- Blocked or free access, entry or exit
- Left or right handed installation

'The Trilock 900 provides a versatile and flexible security entrance for almost every environment'



Safety features

At Boon Edam we put safety first. User safety is an important issue when you are securing your entrance, as well as the possibility to keep your entrance available as an emergency exit.

Emergency

The Trilock 900 is available with fail-safe or fail-secure operation. While the fail-secure model ensures that the entrance stays closed in cases of emergency or power failure, the fail-safe model will free the passage by allowing free rotation of the armset or automatically collapsing the horizontal arm down. If a fire alarm system is connected to the power supply of the Trilock 900, the fail-safe function can automatically be activated upon receipt of a fire alarm signal.

Stylish design

The Trilock 900 is built to high standards using high quality materials, creating a stylish and sophisticated design.

Finishing

The Trilock 900 cabinet is finished with 1.5mm stainless steel, grain 240S, AISI 304, with the three push bars constructed from brushed stainless steel.

Construction

The Trilock 900 is available in a variety of models, by exchanging the end parts. The radius model has a robust and functional charisma. With its slightly curved side panels a smooth look is created, transforming the Trilock 900 into the most stylish model. Various side sections can be combined with an open cabinet body or a variety of inner plates, including straight and angled plates to create a suitable security barrier for almost every environment and budget.

The top plate of the Trilock 900 is detachable to allow easy access to the mechanism below and the possibility of incorporating access control systems. The Trilock 900 mechanism is developed for a long life, using self-lubricating parts.

Options

- Various side part models: radius or fully round edges.
- Various inner plate models: straight and angled.
- Authorisation display with a two colour LED pictogram, arrow/cross, indicating the mechanism status.
- Traffic display, indicating one- or bi-directional passage.
- Adaptation of the unit for installation of a card reader subject to the measurements and characteristics of the reader.
- External soft-touch control panel
- Electrical counter, one or two directions



Standard dimensions and capacity

(mm)	A Unit length	B Passage width	C Arm length	D Arm height	E Unit height	F Cabinet width	G Overall width	Capacity/ person minute
Radius Collapsible	900	492	442	896	1000	230	722	15-20
Radius Rigid	900	437	387	872	1000	230	667	15-20
Round Collapsible	1080	492	442	896	1000	230	722	15-20
Round Rigid	1080	437	387	872	1000	230	667	15-20

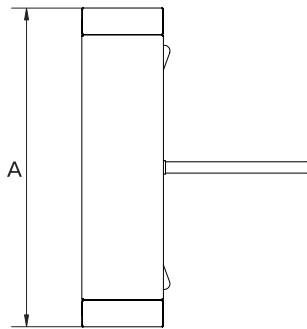
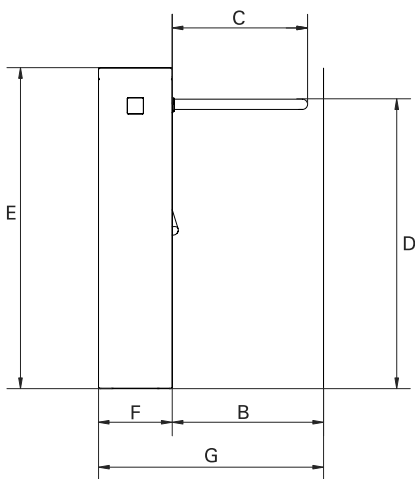

Radius

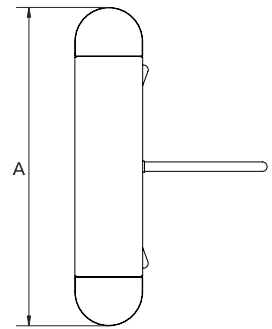

Round

Technical Specifications

Power supply	100-240 VAC, 50/60 Hz
Power consumption:	
Standby mode	15 W
Operating mode	35 W
Ambient temperature	-15 to + 50°C
Weight	80 kg
Compatibility	The Trilock 900 is compatible with most access control systems by using potential free contacts.

High Quality

At Boon Edam, we take quality seriously. Quality of the materials we use, quality of our employees as well as quality of our partners. As with all Boon Edam products, the Trilock 900 is manufactured to the highest standards, is CE approved and complies with the machine directive (98/37/EC), the EMC-directive (2004/108/EC) and the low voltage directive (2006/95/EC).

Distributor

TR-0309-GBR-95903319

Boon Edam B.V.
P.O. Box 40, 1135 ZG Edam
The Netherlands
T +31 (0)299 38 08 08 E sales@boonedam.nl
F +31 (0)299 37 28 59 I www.boonedam.com

 **BOON EDAM**
Security Access