

Circleslide



The elegant curved sliding door

Our Circleslide is a curved automatic sliding door that gives a sensation of space to those entering it. Incorporating self-learning technology, our Circleslide offers extremely smooth and quiet movement. The door provides enough space for people pushing prams or trolleys, carrying luggage and people in wheelchairs. The soft arc appearance and transparent design make the Circleslide an impressive and stylish entrance. The Circleslide can be perfectly integrated into any type of architecture.

Universal entrance solution

A variety of configurations enable us to offer you a suitable entrance solution for almost any building. The Circleslide is also often used in renovation projects to replace regular sliding doors. Curved sliding doors offer wider entrance openings than flat sliding doors.

You will often find our Circleslide in offices, hotels and restaurants, shopping centres and supermarkets, airports and many types of public buildings.

Working principle

The Circleslide is a fully round door with two sets of curved biparting sliding doors and comes with two control panels. The control panels are easy to use and are mounted either on the door itself or at an external location such as a reception desk. Each set of doors can be programmed and operated separately. The following modes are available on the control panel.

Automatic mode

When approaching the Circleslide the first sliding door set opens automatically and the user can enter the door. After entering the Circleslide the second set of sliding doors will automatically open. When a person has passed through the Circleslide, it will close automatically.

One-way mode

The Circleslide only allows people to leave the building.

Winter mode

The Circleslide will operate in the automatic mode but with a reduced opening width in order to save energy costs.

Night mode (closed)

In this mode both door sets are closed. The door sets can be opened once by turning the key switch on the outside or by using the push button on the inside (optional).

Permanently open mode

The Circleslide moves to the open position and remains in this position.

Interlocking mode (optional)

The Circleslide can be fitted with a microprocessor-controlled interlocking function. During normal operation only one door set at a time will be opened. The second door set will only open after the first one has closed. This will prevent draught in your building. In order to prevent queues in front of a closed Circleslide during particularly busy periods, the interlocking function can be deactivated by means of a key inside the Circleslide.

Climate control

In addition to providing an eye-catching entrance, the energy management of your building can be improved.

A Circleslide offers functions to create a separation between the outside and the inside of your building. When used in this way you can create and maintain a more comfortable climate in your building.

Flexible design

The Circleslide has many options in design, including a single biparting sliding door, and surface finishing and can be manufactured to match or complement a wide variety of interiors and facades.

Construction

The curved walls are available in either solid or glazed version. Combinations are also possible. The solid walls are constructed from high-grade aluminium sandwich panels. Glass walls provide a spacious and transparent feeling and consist of slim aluminium sections with laminated glass.

Finishing

The frame and door sets can be finished in powder coated or anodised aluminium (natural or colour). The Circleslide can be covered with stainless steel, bronze, brass or other metals.

Locking

The Circleslide can be locked with an electromechanical lock which is included in the mechanism. It can be unlocked with a manual system or by means of a key impulse switch (option).



Options

- Connection to external alarm system (e.g. fire alarm, smoke detector)
- Floor mat
- Ceiling lighting with halogen or low energy lamps
- Interlocking mode
- Watertight roof
- Glass protection sheets for trolleys
- Air curtain
- Coloured glass
- Push button free out
- Mechanical hookbolt lock

Safety features

At Boon Edam, we put safety first. Our products comply with all relevant safety standards and regulations.

User safety

The Circleslide comes with the following safety features:

1. *Motion and presence sensor*
This sensor has two functions:
 - Detect the presence of people standing between the sliding doors in order to prevent persons or objects being hit by the sliding doors.
 - Detect the motion of people in the Circleslide. If the sensor is activated the sliding door opens automatically.
2. *Stop- and reverse mechanism*
The stop and reverse mechanism ensures that the sliding doors stop or open immediately when they encounter an obstacle while they are opening or closing respectively. The sliding doors will then slowly check their path for obstacles after which they will return to their normal speed.
3. *Emergency push button*
When the button is activated, both door sets will stop immediately. Visitors leaving the building can press an emergency button in the event of emergency, which will immediately stop both door sets.
4. *Side wing sensor (optional)*
The curved sliding movement of the Circleslide is protected by a special sensor, which gives an acoustic signal to advise people who are standing inside the door, in order to prevent an accident caused by the moving sliding door.

Emergency

The Circleslide can be used as an escape route in emergency situations. The door sets will open or close automatically in case of an emergency.

Both sliding door mechanisms have been equipped with an emergency power supply so that the Circleslide remains operational during a power failure.

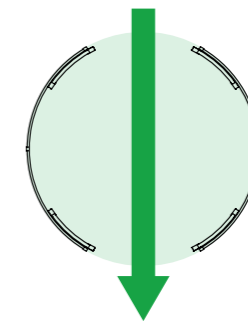

Evacuation path



Standard dimensions

D	A	B	C	E	Escape route	Disabled access
Diameter (mm)	Canopy height (mm)	Height under canopy (mm)	Throat opening (mm)	Installation width (mm)		
1800	300-600	2200-2600	1028	1877		
2000	300-600	2200-2600	1170	2077		
2200	300-600	2200-2600	1312	2277		
2400	300-600	2200-2600	1455	2477		
2600	300-600	2200-2600	1597	2677		
2800	300-600	2200-2600	1739	2877		
3000	300-600	2200-2600	1880	3077		
3200	300-600	2200-2600	1344	3277		
3400	300-600	2200-2600	1444	3477		
3600	300-600	2200-2600	1544	3677		
3800	300-600	2200-2600	1644	3877		

Besides the standard dimensions other options are possible. For more information, please contact our nearest subsidiary or distributor.

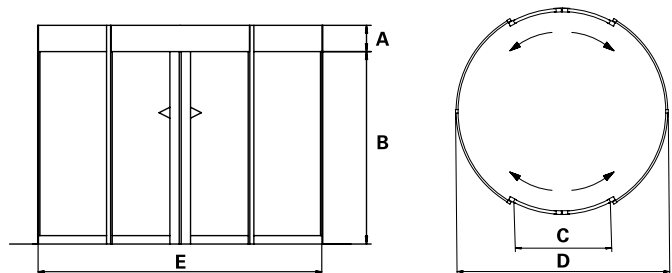

Technical specifications

Power supply	200-240 VAC, 50/60 Hz
Power consumption:	
Operating	50 W
Stationary	30 W
Lighting	80W (halogen) 56 W (low energy)
Fuse	External power supply fused with 10A slow
Ambient temperature	-20°C to +50°C

Function	Range
Closing speed	3-50cm/s
Winter opening width*	20cm-100%
Door open time	0-20s
Opening speed	3-70cm/s

* In the "permanently open" mode, the ONLINE winter opening width is used.

Distributor

High quality

At Boon Edam, we take quality seriously. Quality of the materials we use, the quality of our employees as well as the quality of our partners. As with all Boon Edam products, the Circleslide is manufactured to the highest standards, is CE approved and complies with the Machine Directive (98/37/EEC), the EMC-Directive (89/336/EEC) and the Low Voltage Directive (93/68/EEC).

Many Boon Edam sliding doors have been approved by the Dutch Council for the Chronically ill and the Disabled as being accessible for disabled people. When you install the Circleslide in your building, your entrance will meet the requirements of the international accessibility symbol (ITS).

